

Pin NUMBER	SIGNAL NAME
1	VBUS
2	D-
3	D+
4	GND
5	StdA_SSRX-
6	StdA_SSRX+
7	GND_DRAIN
8	StdA_SSTX-
9	StdA_SSTX+
Shell	Shield

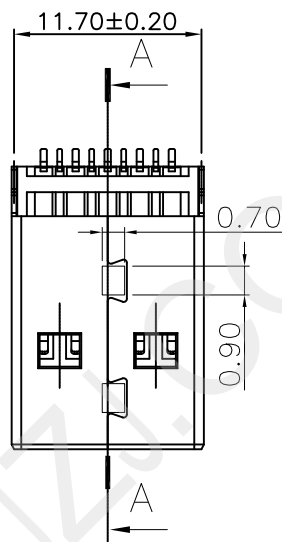

Notes:

- Material:
 Insulator : Thermoplastic G.F. UL94V-0,BULE
 Contacts : Copper Alloy
 Shell : SPCC
- Environmental :
 -55°C to +105°C
- Electrical
 Voltage : 30VAC(R.M.S)
 Current Rating : 1.5 Ampere Min.
 Contact resistance : 30 Milliohms Max.
 Insulation resistance : 100 Megohms Min.
 Dielectric withstanding voltage : 500 VAC
- Finish
 Shell : 50u" min. Nickel
 Contacts : 1~30u" min. Gold on mating area.
 100u" min. Tin on the tails.

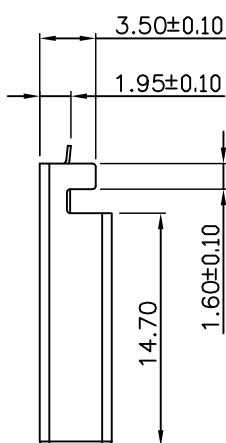
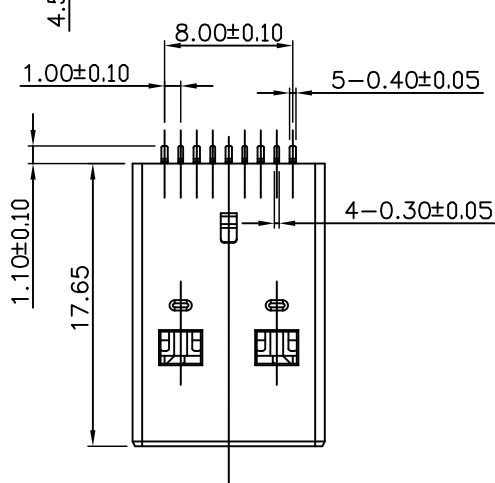
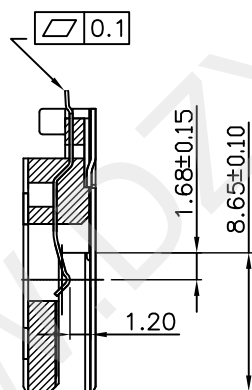
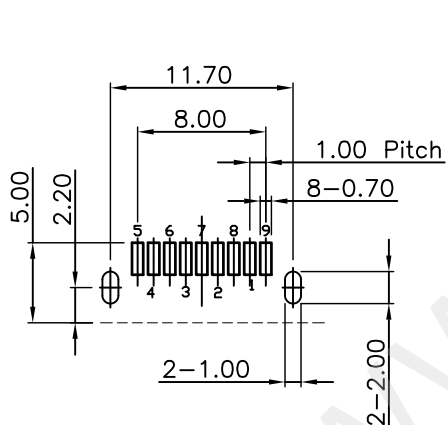

SECTION "A-A"



深圳市华宇创精密电子有限公司

TOLERANCE: X.X ±0.30 X.XX ±0.25 X.XXX ±0.15 X: ±2' X.X' ±0.5'	DRAWN BY : 陈一鸣	DATE : 2014-02-23	PART NAME: USB 3.0 AM 沉板1.9 L=17.6 无柱
	CHECKED BY: 马跃	DATE : 2014-02-23	PART NO. : HVC180-USBA09-190
 UNIT: mm [inch] SCALE:1:1 SIZE: A4	APPROVED BY: 邱敏	DATE : 2014-02-23	MOLD NO. : /
			DRAW NO. : HVC-2603201130
			SHEET NO. : 1 OF 1